



KERN & Sohn GmbH

Ziegelei 1
D-72336 Balingen
E-Mail: info@kern-
sohn.com

Phone: +49-[0]7433- 9933-0
Fax: +49-[0]7433-9933-149
Internet: www.kern-sohn.com

Installation Instructions

Hook and shackle set

KERN YHA / YSC

Version 1.0
2017-09
GB

Type YHA-01	Type YSC-01
Type YHA-02	Type YSC-02
Type YHA-03	Type YSC-03
Type YHA-04	
Type YHA-05	
Type YHA-06	



KERN YHA



KERN YSC

YHA_YSC-IA-e-1710



KERN YHA /YSC

Version 1.0 2017-09

Installation instructions for hook set

Contents

1	General hints	2
2	Scope of delivery	3
3	Installation	5
4	Regular maintenance and care	7

1 General hints

These installation instructions include all of the information for installing the hook and shackle for the KERN HFA, HFC, HCB and HCN crane scales.

HFA / HFC [Max] \leq 1 t:	KERN YHA-01
HFA / HFC [Max] = 3 t:	KERN YHA-02
HFA / HFC [Max] = 5 t:	KERN YHA-03
HFA / HFC [Max] > 5 t:	KERN YHA-04
HCB [Max] \leq 1 t:	KERN YHA-05
HCB [Max] 100 kg - 1 t:	KERN YHA-06
HCN [Max] 100 kg – 200kg:	
HFA / HFC [Max] \leq 1 t – 5 t:	KERN YSC-01
HFA / HFC [Max] = 10 t:	KERN YSC-02
HCB [Max] \leq 1 t:	KERN YSC-03

2 Scope of delivery

KERN YHA

- Hook with safety lock

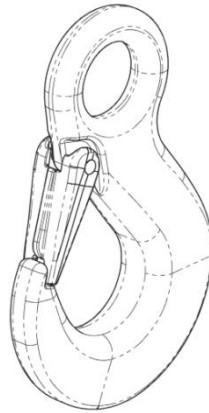

- 2 x shackles

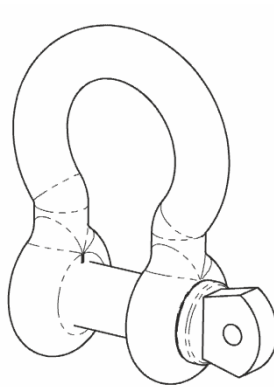

- Connecting link

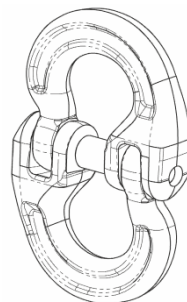

- Bolt and double leaf spring for the connecting link



- Installation Instructions
- Assembly instructions

KERN YSC

- 2 x shackles

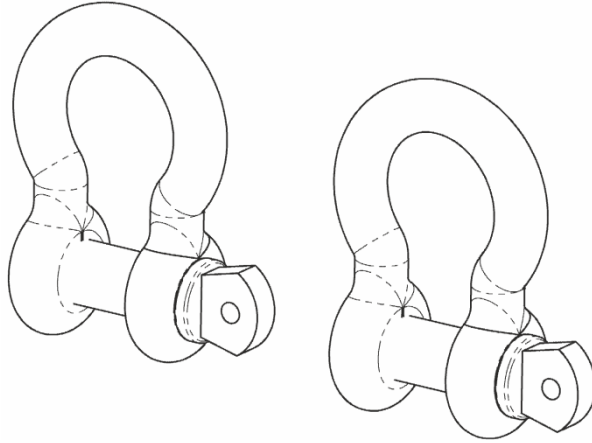

- Installation Instructions
- Assembly instructions

3 Installation

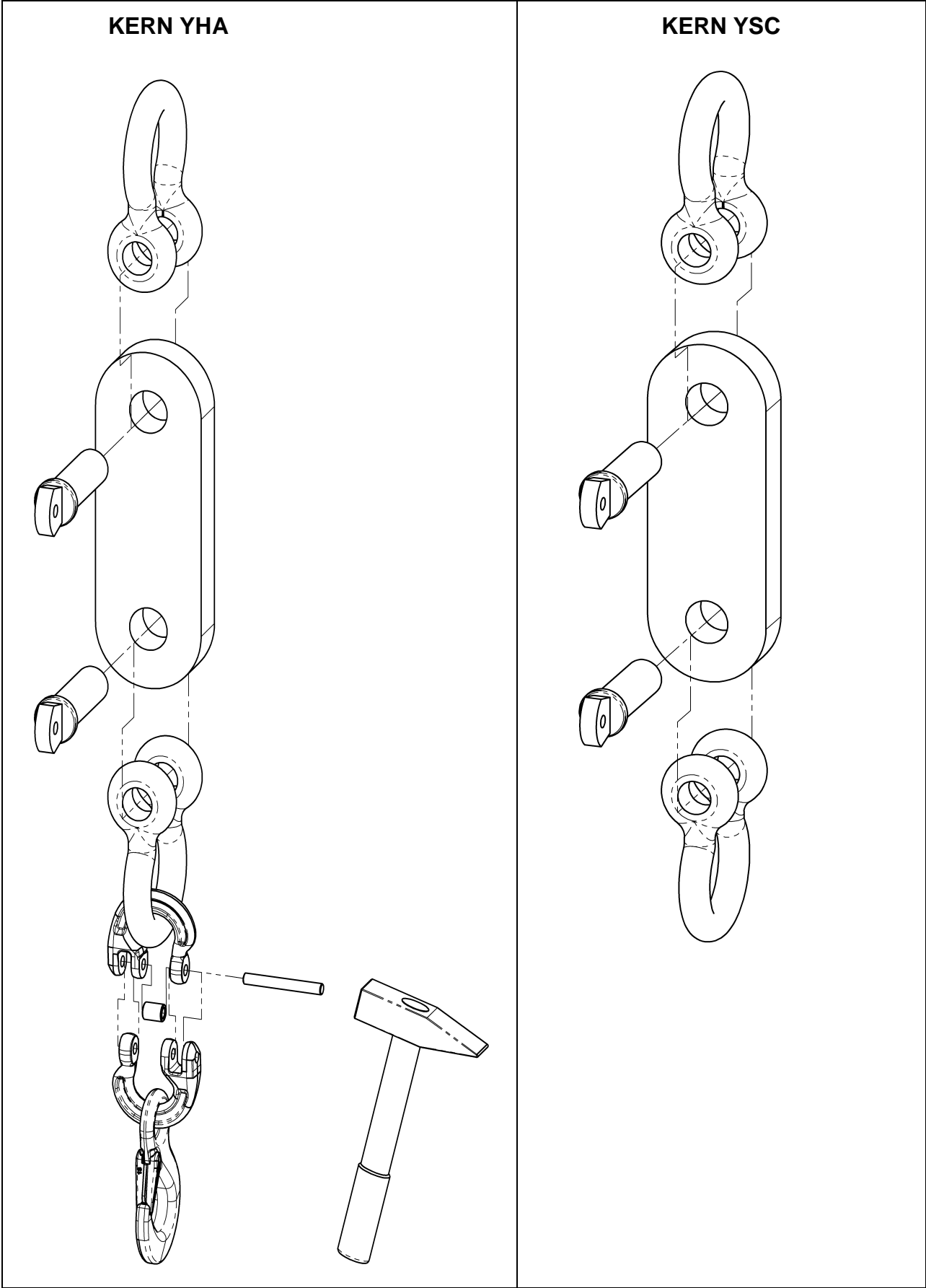

Check after assembly that:

- ❶ the threaded bolts on the lower and upper shackles are fully-tightened.
- ❷ the integrated bolt in the connecting link is blocked correctly by the double leaf springs.
- ❸ the safety bracket is working properly

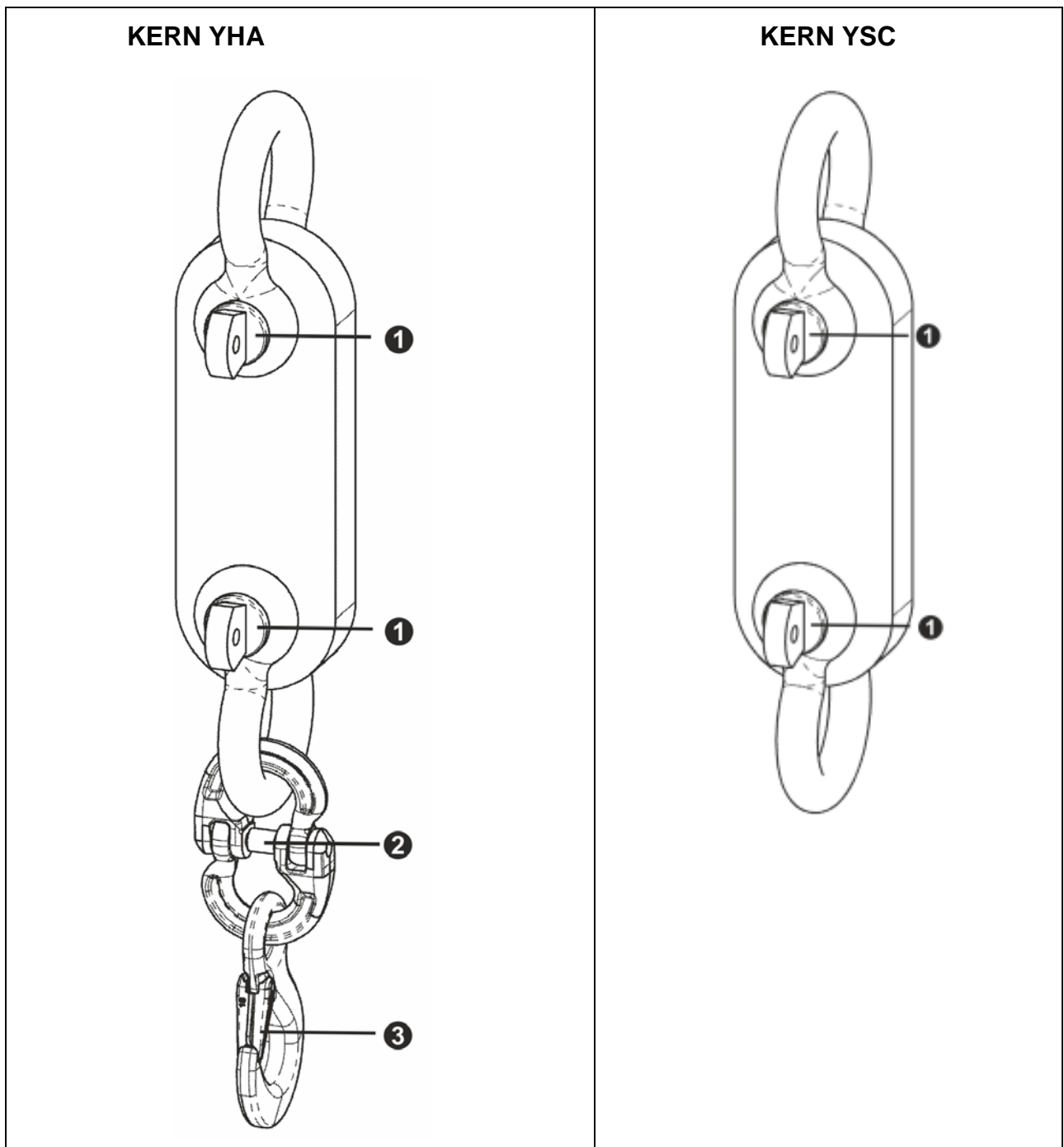

➤ Refer to the accompanying assembly instructions for further directions.

4 Regular maintenance and care

Maintenance may only be carried out by a specialist technician with specific training in dealing with load-lifting gear and crane scales.

- ☞ Check the used attachment device regularly for wear and tear, such as e.g. plastic deformation, mechanical damage (unevenness), notches, striation, cracks, corrosion, thread damage and torsions.
- ☞ Check the application of the safety bracket on the hook, moreover check for fault and correct function
- ☞ Load suspension devices known to have been overloaded or subject to other harmful influences may no longer be used and/or may be re-used only after inspection.
- ☞ **Refer to the accompanying assembly instructions for further directions.**