

Quick start guide

first configuration of BleBox controllers

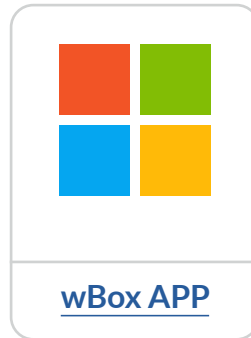

Table of contents

1	How to use wBox app	p. 2
	1.1 Account	
	2.1 Tutorial of the wBox application	
2	How to configure a new BleBox device	p. 3
	2.1 Connect the phone with the BleBox controller	
	2.2 Configure a new BleBox device	
	2.3 Turn off or set password to BleBox AP	
3	How to add configured BleBox device to another account	p. 7
	3.1 Search for BleBox controllers connected to the WiFi network	
	3.2 Sharing controllers via e-mail	

for more information please visit the website

www.blebox.eu

or send an email to: info@blebox.eu

technical support is available at: support@blebox.eu

proudly made by
blebox

1.1

At the launch of wBox app, it will ask you to log in or create an account.

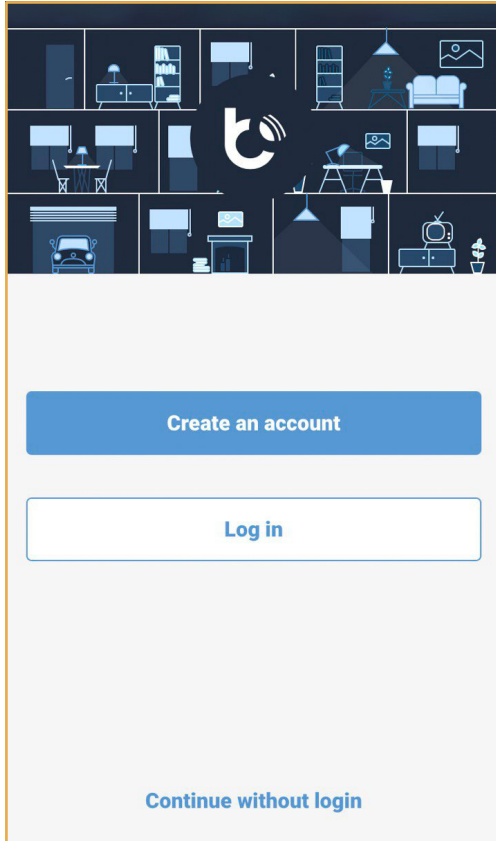

You can create the **BleBox** account or log in using your **Google**, **Apple** or **Facebook** account.

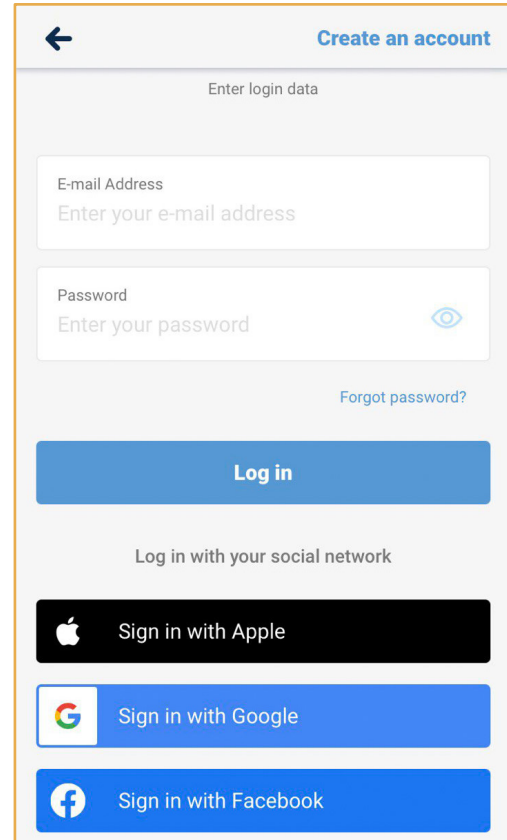

You can continue without login (dedicated for installers for one-time connection of the controller), but the features of the app will be limited.

We strongly recommend to create an account or log in.

1.2 How to use wBox app - wBox app Tutorial

1.2

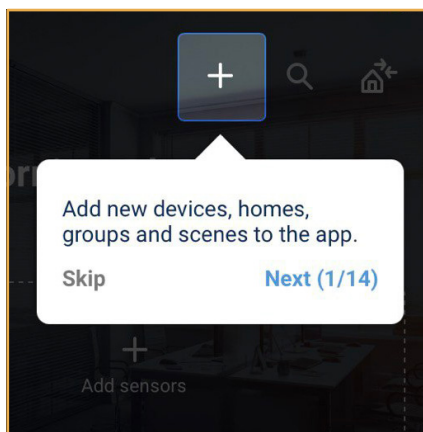

After logging in, the **wBox** tutorial will automatically appear.

If you don't see the tutorial, click on the „Menu”, ☰ and then on „How to use”.

2.1

Connect the phone with the BleBox controller.

iOS version

iOS



Please turn off mobile network/
cellular data in your phone.

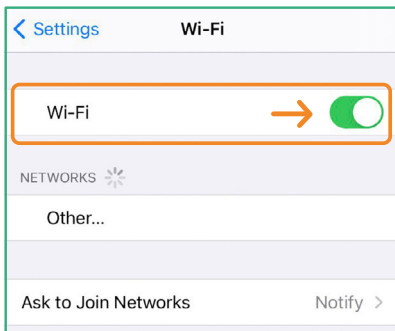

Please select WiFi settings in
your phone and turn on WiFi
network.

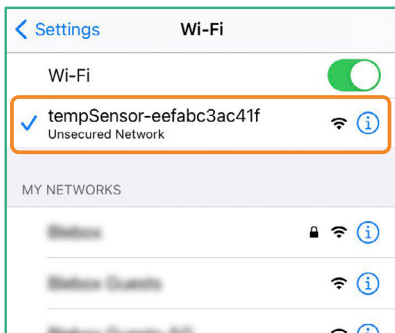

Connect to the WiFi network
provided by the controller, for
example: - „device-xxxxxxx“,
where xxxxxxxx is the
unique number of the device.

Android version

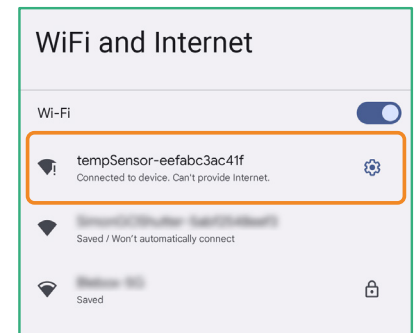
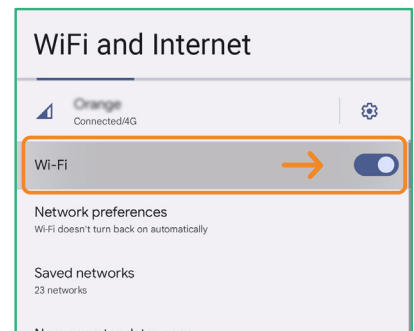
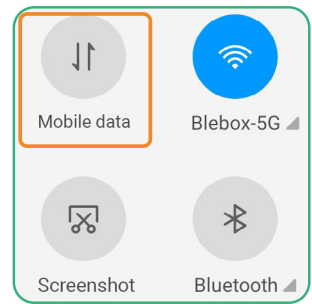

Connected!

Some phones may report that **“Internet may not be available”** - it's normal, please continue with this WiFi network.

After connecting to the WiFi network of the BleBox controller, return to the wBox application .

Version A

Please use „+ Add device to account” button to add the device to your account. Now you became the owner of the device.

1

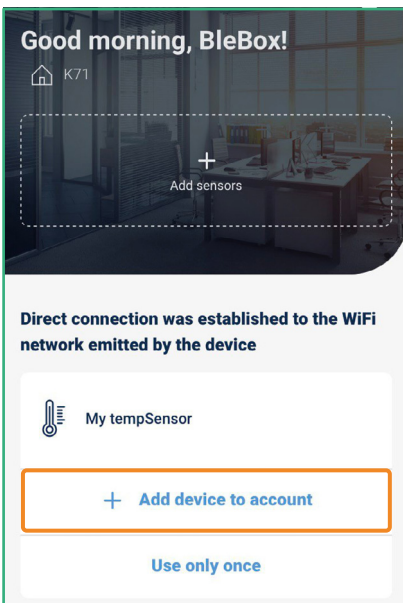

Ready!

You have added the device to your account. Then „Go to WiFi settings”.

* If the message did not appear or you clicked „Cancel”, please refer to version B (page 5).

2

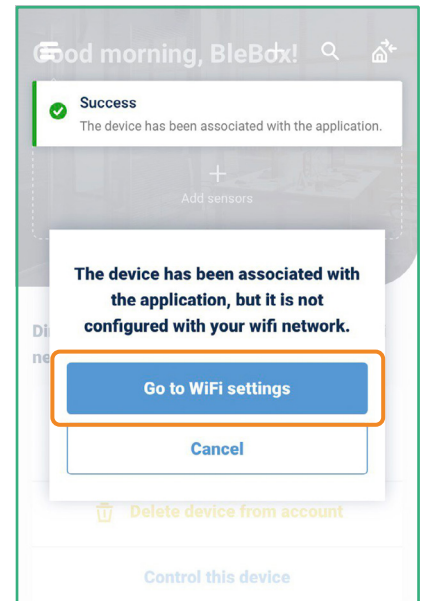

Select your home WiFi network from the list to connect the controller with this network.

3

Remember!

The owner of the device has the right to grant and revoke access to the device to other users.

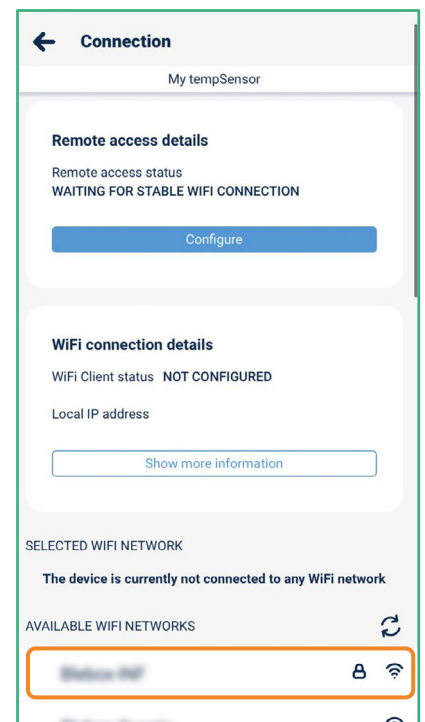

WiFi Client status: connected!

The BleBox controller is connected to your home WiFi network.

Further part of the manual: - page 6, p.2.3

5

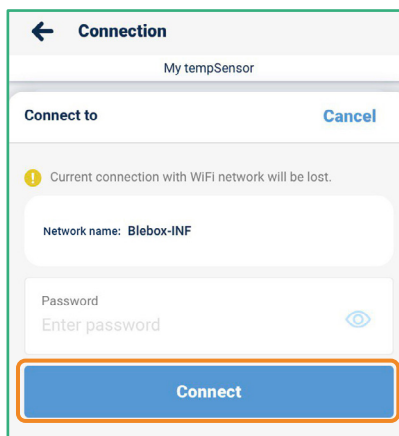
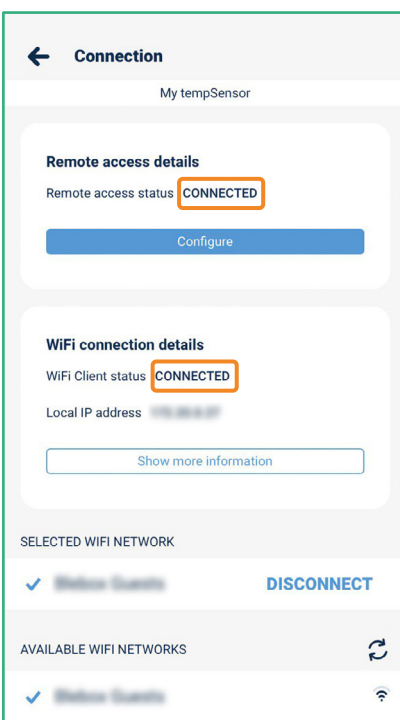

Enter your home WiFi password, then click „Connect”.

4

Version B

If you didn't see a message after adding the device to your account or you clicked „Cancel”, go to WiFi network settings. Select „Control this device”.

1

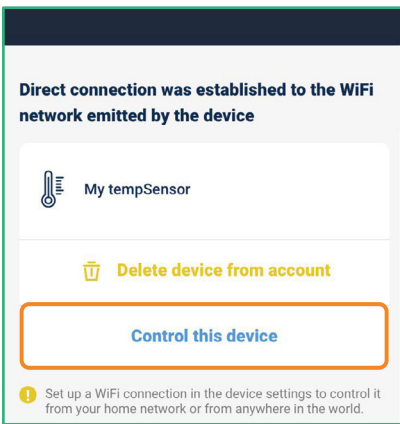

Find and click the settings icon ⚙️.

2

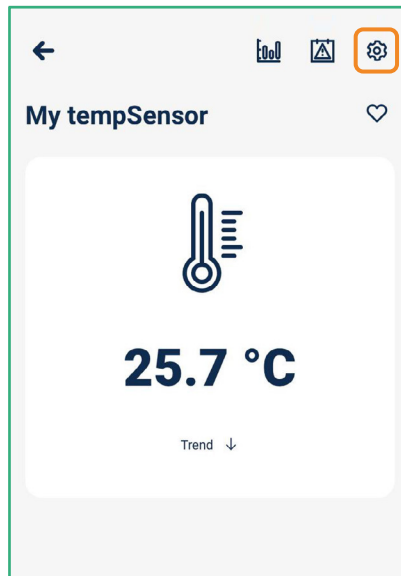

Click on „Connection”.

3

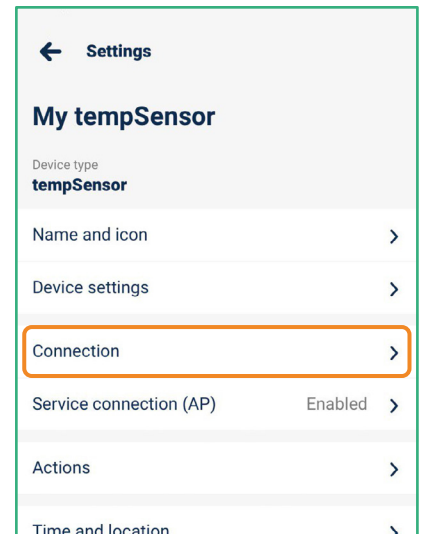

Select your home WiFi network from the list to connect the controller to this network.

4

Remember!

The owner of the device has the right to grant and revoke access to the device to other users.

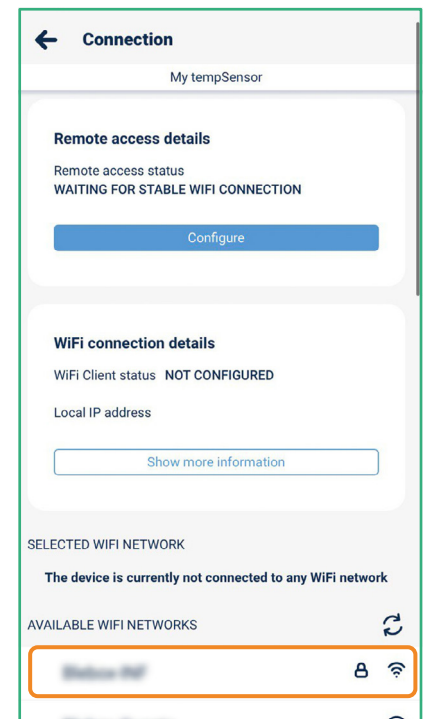

WiFi Client Status: Connected

The BleBox controller has been connected to the home WiFi network.

6

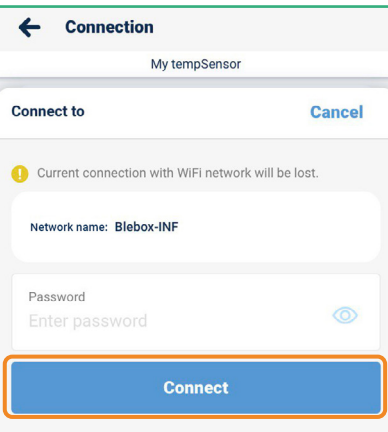
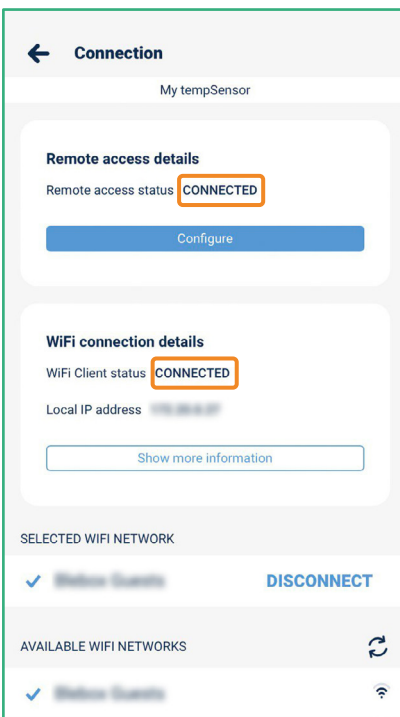

Enter your home WiFi password, then click „Connect”.

5

2.3

Disable or set a password for the service connection.

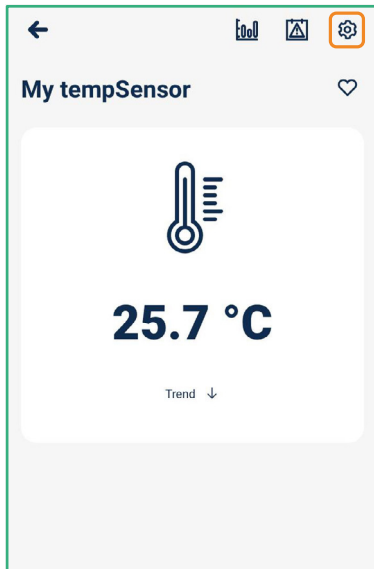

Click the settings icon .

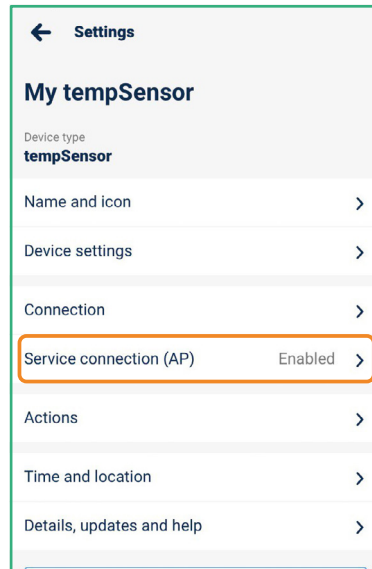

Go to the „Service Connection (AP)” section.

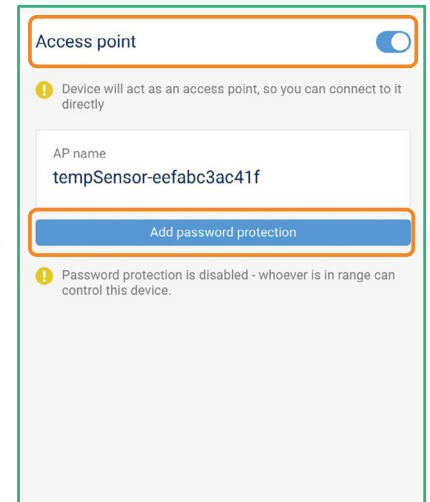

Here you can **disable the access point** or **set a password for the AP to prevent unauthorized access.**

That's all!

For more information about your specific device, see the user guides.

Please continue below if you want to see how to share a configured device with another family member.

3.1 Add configured controller using another smartphone.

Find the „+” icon at the top of the screen.

1

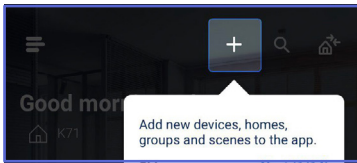

Click „Add New Device”.

2

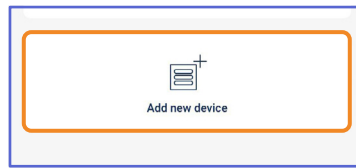

Select „Add devices already connected to the WiFi network”.

3

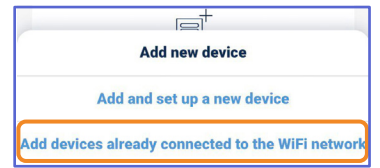

Click „Finish”, the drivers will be added.

6

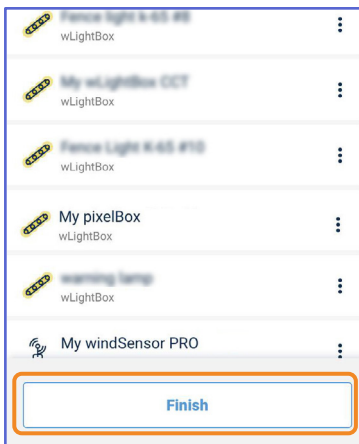

Select the devices you want to add to your account and press „Save”.

5

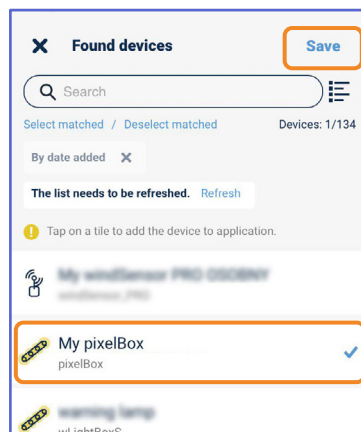

Select „Scan for devices” for devices and wait for the scan to complete.

4

Remember that you must be connected to the same WiFi network as the BleBox controller.

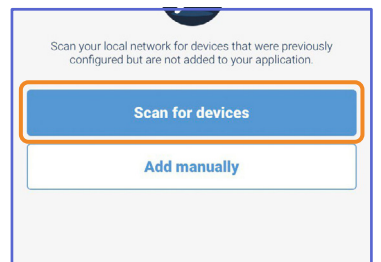

That's all!

You can go back to the dashboard or add controllers to specific home.

3.2

Sharing controllers via e-mail.

Use "Manage all devices" option in wBox app menu .

Use share option in μ Portal <https://portal.blebox.eu>.

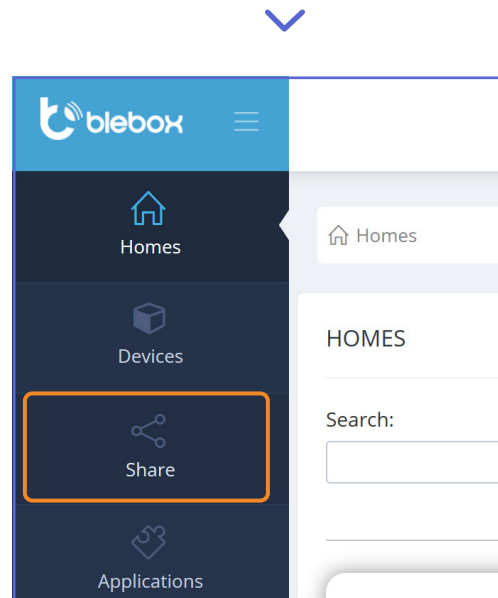
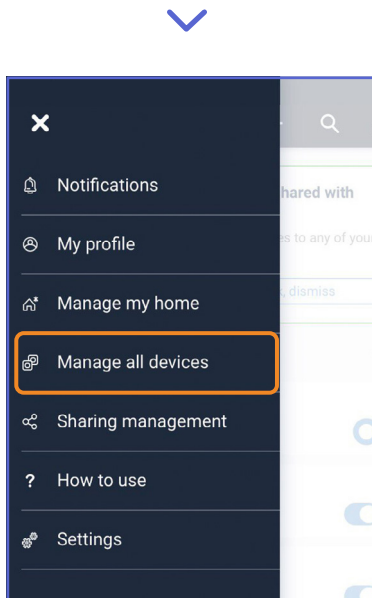

for more information please visit the website

www.blebox.eu

or send an email to: info@blebox.eu
technical support is available at: support@blebox.eu

proudly made by
blebox